

REFERENCE

CFM-001

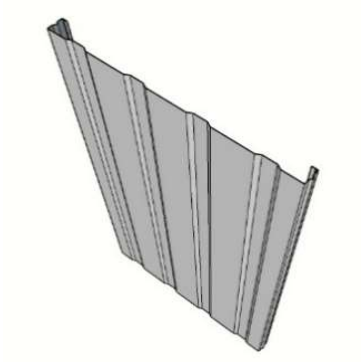

<u>PART DESC</u>	<u>MATERIAL</u>	<u>COLOUR</u>	<u>UNIT</u> £
CORRIDOR PANEL	H.G.P.	WHITE	PLM

REFERENCE

CFM-002

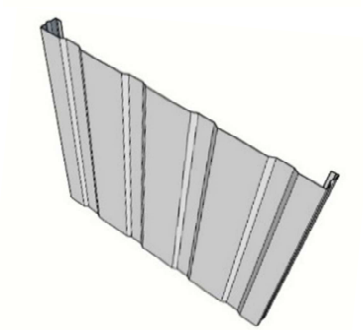

<u>PART DESC</u>	<u>MATERIAL</u>	<u>COLOUR</u>	<u>LENGTH MM</u>	<u>UNIT</u> £
CDR HEADER PANEL	H.G.P.	WHITE		PLM

REFERENCE

CFM-003

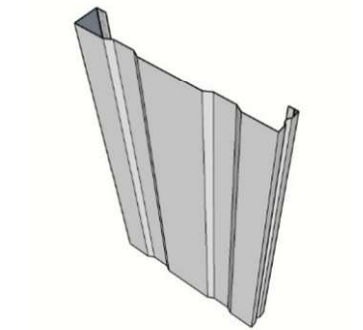

<u>PART DESC</u>	<u>MATERIAL</u>	<u>COLOUR</u>	<u>LENGTH MM</u>	<u>UNIT</u> £
H PANEL (250 COVER)	H.G.P.	WHITE		PLM

REFERENCE

CFM-004

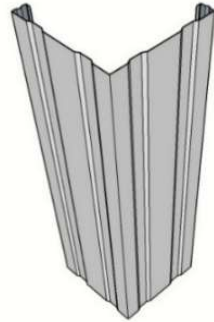

<u>PART DESC</u>	<u>MATERIAL</u>	<u>COLOUR</u>	<u>LENGTH MM</u>	<u>UNIT £</u>
90 DEG CRNR PANEL	H.G.P.	WHITE		PLM

REFERENCE

CFM-005

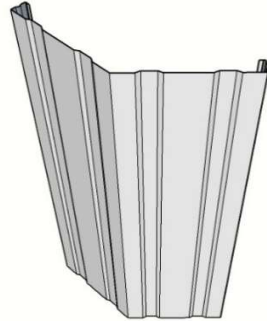

<u>PART DESC</u>	<u>MATERIAL</u>	<u>COLOUR</u>	<u>LENGTH MM</u>	<u>UNIT £</u>
45 DEG CRNR PANEL	H.G.P.	WHITE		PLM

REFERENCE

CFM-006

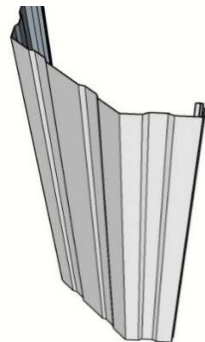

<u>PART DESC</u>	<u>MATERIAL</u>	<u>COLOUR</u>	<u>LENGTH MM</u>	<u>UNIT £</u>
FACETTED CRNR	H.G.P.	WHITE		PLM

REFERENCE

CFM-007

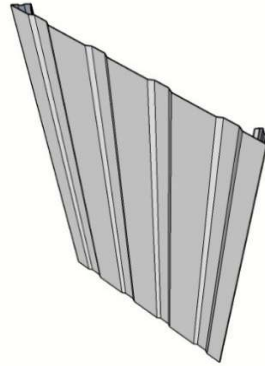

<u>PART DESC</u>	<u>MATERIAL</u>	<u>COLOUR</u>	<u>LENGTH MM</u>	<u>UNIT £</u>
45 DEG CRNR EDGES	H.G.P.	WHITE		PLM

REFERENCE

CFM-008

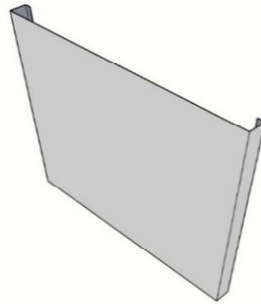

<u>PART DESC</u>	<u>MATERIAL</u>	<u>COLOUR</u>	<u>LENGTH MM</u>	<u>UNIT £</u>
CORRIDOR PNL FLAT	PLASTISOL	WHITE		PLM

REFERENCE

CFM-009

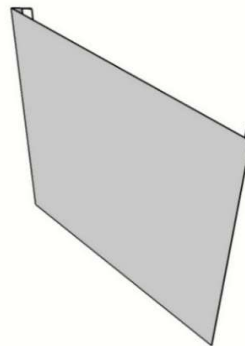

<u>PART DESC</u>	<u>MATERIAL</u>	<u>COLOUR</u>	<u>LENGTH MM</u>	<u>UNIT £</u>
45 DEG CRNR EDGES	PLASTISOL	WHITE		PLM

REFERENCE

CFM-010

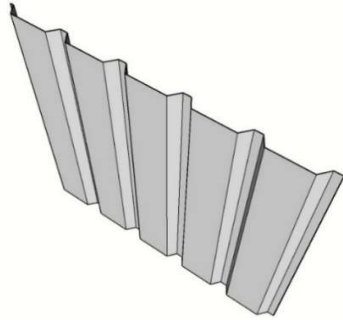

<u>PART DESC</u>	<u>MATERIAL</u>	<u>COLOUR</u>	<u>LENGTH MM</u>	<u>UNIT £</u>
PROFILE PANEL	PLASTISOL	WHITE		PLM

REFERENCE

CFM-011

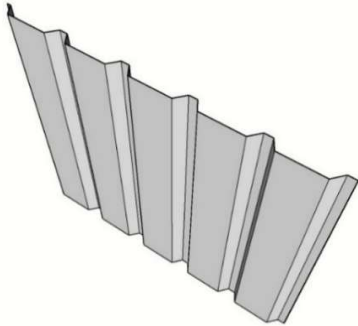

<u>PART DESC</u>	<u>MATERIAL</u>	<u>COLOUR</u>	<u>LENGTH MM</u>	<u>UNIT £</u>
PROFILE H PANEL	PLASTISOL	WHITE		PLM

REFERENCE

CFM-012

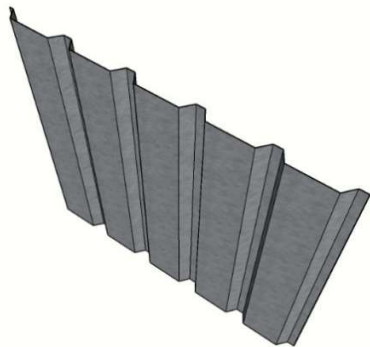

<u>PART DESC</u>	<u>MATERIAL</u>	<u>COLOUR</u>	<u>LENGTH MM</u>	<u>UNIT £</u>
PARTITION PANEL	ZINC	MILL		PLM

REFERENCE

CFM-013

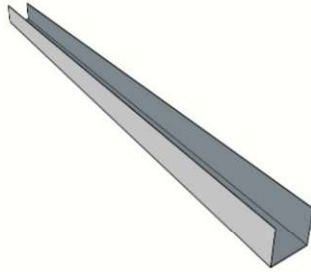

<u>PART DESC</u>	<u>MATERIAL</u>	<u>COLOUR</u>	<u>LENGTH MM</u>	<u>UNIT £</u>
CORRIDOR TRACK	H.G.P.	MILL	3000	PLM

REFERENCE

CFM-014

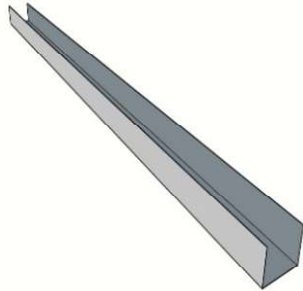

<u>PART DESC</u>	<u>MATERIAL</u>	<u>COLOUR</u>	<u>LENGTH MM</u>	<u>UNIT £</u>
CORRIDOR TRACK	PLASTISOL	WHITE	3000	PLM

REFERENCE

CFM-015



<u>PART DESC</u>	<u>MATERIAL</u>	<u>COLOUR</u>	<u>LENGTH MM</u>	<u>UNIT £</u>
PARTITION TRACK	GALV	MILL	3000	PLM

REFERENCE

CFM-013

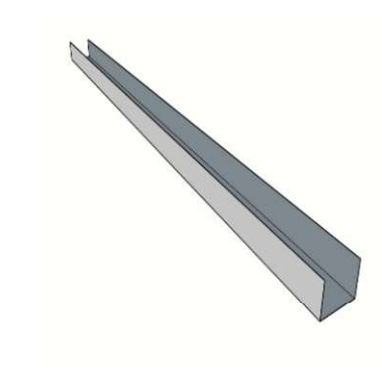

<u>PART DESC</u>	<u>MATERIAL</u>	<u>COLOUR</u>	<u>LENGTH MM</u>	<u>UNIT £</u>
CORRIDOR POST	H.G.P.	MILL		PLM

REFERENCE

CFM-014

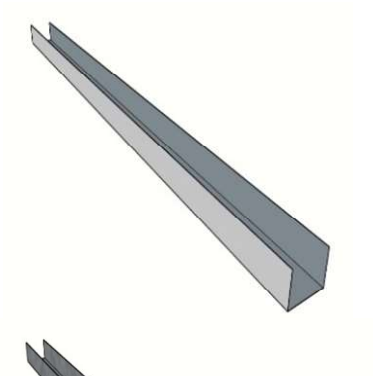

<u>PART DESC</u>	<u>MATERIAL</u>	<u>COLOUR</u>	<u>LENGTH MM</u>	<u>UNIT £</u>
CORRIDOR POST	PLASTISOL	MILL		PLM

REFERENCE

CFM-015

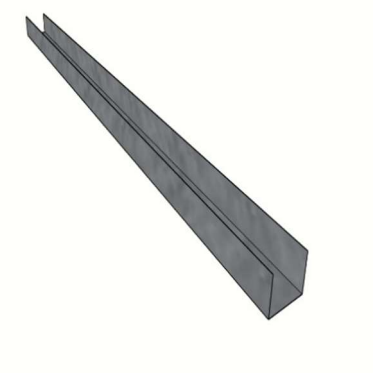

<u>PART DESC</u>	<u>MATERIAL</u>	<u>COLOUR</u>	<u>LENGTH MM</u>	<u>UNIT £</u>
PARTITION POST	GALV	MILL		PLM

REFERENCE

CFM-016

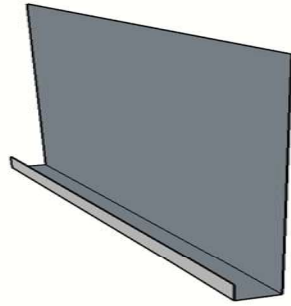

<u>PART DESC</u>	<u>MATERIAL</u>	<u>COLOUR</u>	<u>LENGTH MM</u>	<u>UNIT £</u>
SKIRTING TRACK	GALV / PPC			PLM

REFERENCE

CFM-017

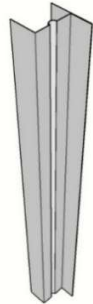

<u>PART DESC</u>	<u>MATERIAL</u>	<u>COLOUR</u>	<u>LENGTH MM</u>	<u>UNIT £</u>
DOOR JAMB	H.G.P.	WHITE		PLM

REFERENCE

CFM-018



<u>PART DESC</u>	<u>MATERIAL</u>	<u>COLOUR</u>	<u>LENGTH MM</u>	<u>UNIT £</u>
FLAT DOOR JAMB	PLASTISOL	WHITE		PLM

REFERENCE

CFM-019



PART DESC MATERIAL COLOUR LENGTH MM UNIT £

PROFILE DOOR JAMB GALV / PPC PLM

REFERENCE

CFM-020



PART DESC MATERIAL COLOUR LENGTH MM UNIT £

Z'D DR JMB SLOT L/H GALV / PPC PLM

REFERENCE

CFM-021

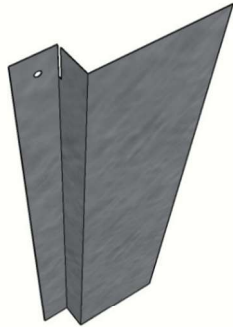

PART DESC MATERIAL COLOUR LENGTH MM UNIT £

Z'D DR JMB SLOT R/H GALV / PPC PLM

REFERENCE

CFM-022

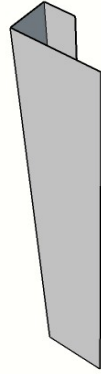

<u>PART DESC</u>	<u>MATERIAL</u>	<u>COLOUR</u>	<u>LENGTH MM</u>	<u>UNIT £</u>
ROLLER SHUT JAMB	H.G.P.	WHITE		PLM

REFERENCE

CFM-023



<u>PART DESC</u>	<u>MATERIAL</u>	<u>COLOUR</u>	<u>LENGTH MM</u>	<u>UNIT £</u>
ROLLER SHUT JAMB	GALV / PPC			PLM

REFERENCE

CFM-024

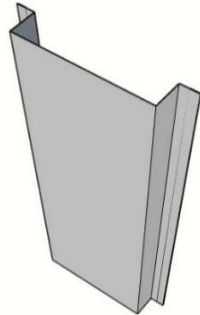

<u>PART DESC</u>	<u>MATERIAL</u>	<u>COLOUR</u>	<u>LENGTH MM</u>	<u>FACE MM</u>
DOUBLE JAMB	H.G.P.	WHITE		

REFERENCE

CFM-025

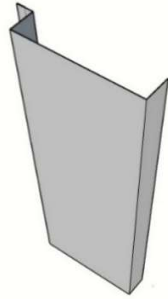

<u>PART DESC</u>	<u>MATERIAL</u>	<u>COLOUR</u>	<u>LENGTH MM</u>	<u>FACE MM</u>
SINGLE SIDE JAMB	H.G.P.	WHITE		

REFERENCE

CFM-026

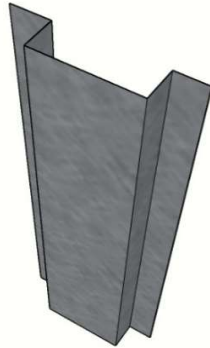

<u>PART DESC</u>	<u>MATERIAL</u>	<u>COLOUR</u>	<u>LENGTH MM</u>	<u>FACE MM</u>
DOUBLE SIDE JAMB	GALV / PPC			

REFERENCE

CFM-027

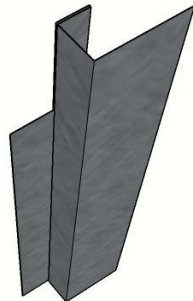

<u>PART DESC</u>	<u>MATERIAL</u>	<u>COLOUR</u>	<u>LENGTH M</u>	<u>NOTCH</u>
NTCH DR JAMBS R/H	GALV / PPC			

REFERENCE

CFM-028

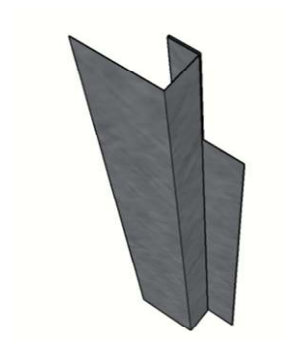

PART DESC MATERIAL COLOUR LENGTH M NOTCH

NTCH DR JAMBS L/H GALV / PPC

REFERENCE

CFM-013-M

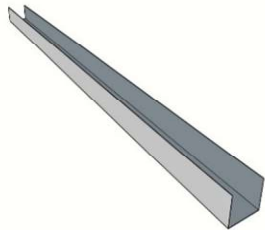

PART DESC MATERIAL COLOUR LENGTH MM UNIT

DOOR HEADER BAR H.G.P. WHITE PLM

REFERENCE

CFM-029



PART DESC MATERIAL COLOUR LENGTH MM UNIT

DOOR HEADER BAR GALV / PPC PLM

REFERENCE

CFM-030

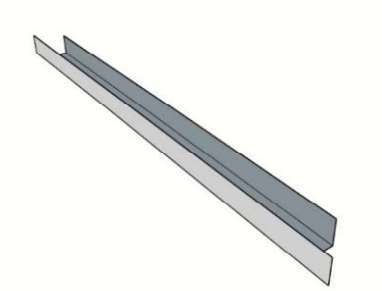

<u>PART DESC</u>	<u>MATERIAL</u>	<u>COLOUR</u>	<u>LENGTH MM</u>	<u>UNIT</u>
TABBED HEADER BAR	H.G.P.	WHITE		PLM

REFERENCE

CFM-031



<u>PART DESC</u>	<u>MATERIAL</u>	<u>COLOUR</u>	<u>LENGTH MM</u>	<u>UNIT</u>
TABBED HEADER BAR	GALV / PPC			PLM

REFERENCE

CFM-032

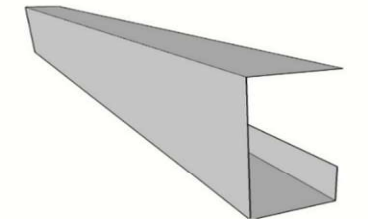

<u>PART DESC</u>	<u>MATERIAL</u>	<u>COLOUR</u>	<u>LENGTH MM</u>	<u>FACE MM</u>
FLAT DOOR HEADER	PLASTISOL	WHITE		

REFERENCE

CFM-033

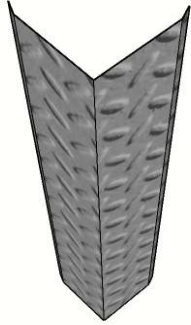

<u>PART DESC</u>	<u>MATERIAL</u>	<u>COLOUR</u>	<u>LENGTH MM</u>	<u>UNIT</u>
90 DEG EXT CORNER	ALY CHEQ	MILL		PLM

REFERENCE

CFM-034



<u>PART DESC</u>	<u>MATERIAL</u>	<u>COLOUR</u>	<u>LENGTH MM</u>	<u>UNIT</u>
90 DEG INT CORNER	ALY CHEQ	MILL		PLM

REFERENCE

CFM-035

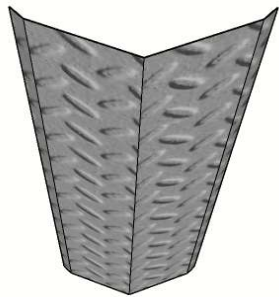

<u>PART DESC</u>	<u>MATERIAL</u>	<u>COLOUR</u>	<u>LENGTH M</u>	<u>UNIT</u>
135 DG EXT CORNER	ALY CHEQ	MILL		PLM

REFERENCE

CFM-036

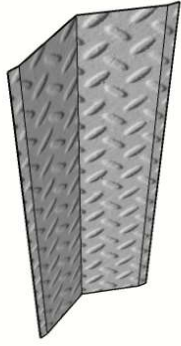

<u>PART DESC</u>	<u>MATERIAL</u>	<u>COLOUR</u>	<u>LENGTH MM</u>	<u>UNIT</u>
135 DG INT CORNER	ALY CHEQ	MILL		PLM

REFERENCE

CFM-037



<u>PART DESC</u>	<u>MATERIAL</u>	<u>COLOUR</u>	<u>LENGTH MM</u>	<u>FACE MM</u>
90 DEG EXT CORNER	GALV	MILL		PLM

REFERENCE

CFM-038



<u>PART DESC</u>	<u>MATERIAL</u>	<u>COLOUR</u>	<u>LENGTH MM</u>	<u>UNIT</u>
90 DEG INT CORNER	GALV	MILL		PLM

REFERENCE

CFM-039



PART DESC MATERIAL COLOUR LENGTH MM UNIT

135 DEG EXT CORNER GALV MILL PLM

REFERENCE

CFM-040



PART DESC MATERIAL COLOUR LENGTH M UNIT

135 DEG INT CORNER GALV MILL PLM

REFERENCE

CFM-041

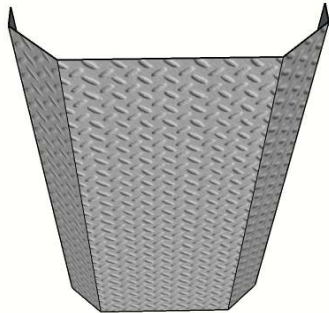

PART DESC MATERIAL COLOUR LENGTH MM UNIT

FCTTD CNR GUARD ALY CHEQ MILL PLM

REFERENCE

CFM-042

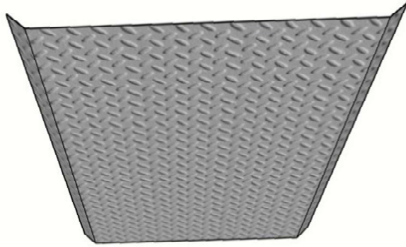

PART DESC	MATERIAL	COLOUR	LENGTH MM	UNIT
45 DG CRNR GUARD	ALY CHEQ	MILL		PLM

REFERENCE

CFM-043

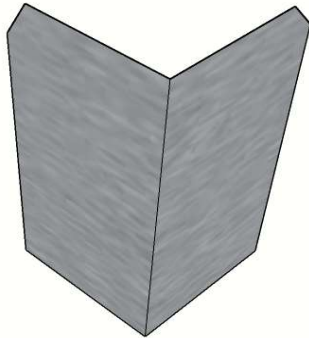

PART DESC	MATERIAL	COLOUR	LENGTH MM	UNIT
90 DG EXT C GUARD	GALV /PPC			PLM

REFERENCE

CFM-044

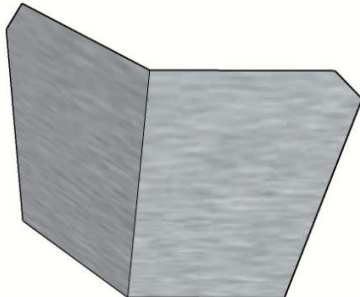

PART DESC	MATERIAL	COLOUR	LENGTH MM	UNIT
135 DG EXT C GUARD	GALV /PPC			PLM

REFERENCE

CFM-045



PART DESC MATERIAL COLOUR LENGTH MM UNIT

90 DG INT C GUARD GALV /PPC PLM

REFERENCE

CFM-046

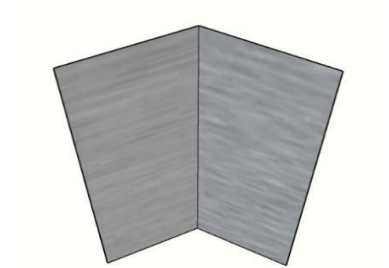

PART DESC MATERIAL COLOUR LENGTH MM UNIT

135 DG INT C GUARD GALV /PPC PLM

REFERENCE

CFM-047

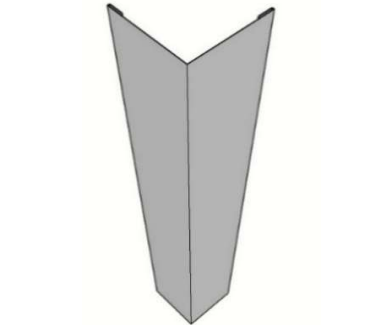

PART DESC MATERIAL COLOUR LENGTH MM UNIT

90 DEG EXT CORNER H.G.P. WHITE PLM

REFERENCE

CFM-048

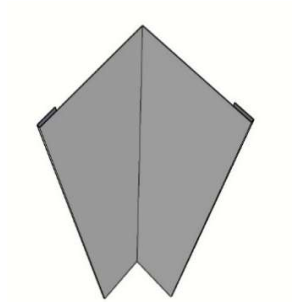

PART DESC MATERIAL COLOUR LENGTH MM UNIT

90 DEG INT CORNER H.G.P. WHITE PLM

REFERENCE

CFM-049

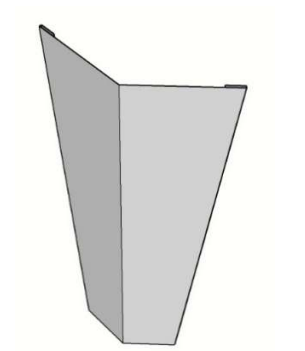

PART DESC MATERIAL COLOUR LENGTH MM UNIT

135 DEG EXT CORNER H.G.P. WHITE PLM

REFERENCE

CFM-050

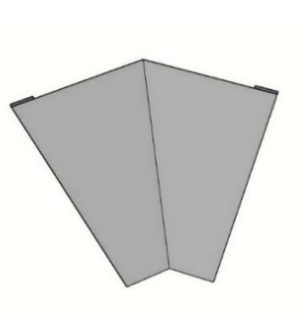

PART DESC MATERIAL COLOUR LENGTH MM UNIT

135 DEG INT CORNER H.G.P. WHITE PLM

REFERENCE

CFM-051

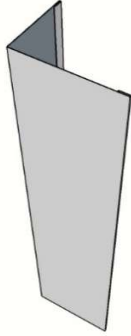

PART DESC	MATERIAL	COLOUR	LENGTH MM	UNIT
90D EXT CNR 103X70	PLASTISOL	WHITE		PLM

REFERENCE

CFM-052

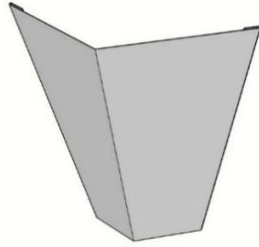

PART DESC	MATERIAL	COLOUR	LENGTH MM	UNIT
135D EXT CNR 103X70	PLASTISOL	WHITE		PLM

REFERENCE

CFM-053

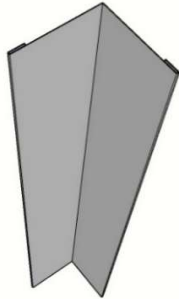

PART DESC	MATERIAL	COLOUR	LENGTH MM	UNIT
90D INT CNR 57X57	PLASTISOL	WHITE		PLM

REFERENCE

CFM-054

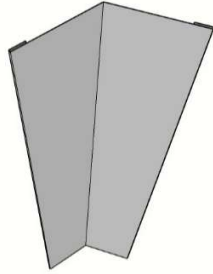

<u>PART DESC</u>	<u>MATERIAL</u>	<u>COLOUR</u>	<u>LENGTH MM</u>	<u>UNIT</u>
135D INT CNR 57X57	PLASTISOL	WHITE		PLM

REFERENCE

CFM-055

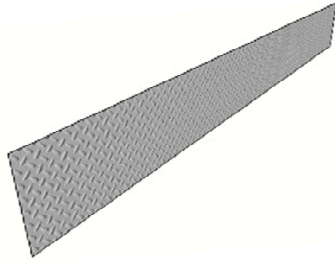

<u>PART DESC</u>	<u>MATERIAL</u>	<u>COLOUR</u>	<u>LENGTH MM</u>	<u>UNIT</u>
	1			
300MM KICK PLATE	ALY CHEQ	MILL	2500	EACH

REFERENCE

CFM-056

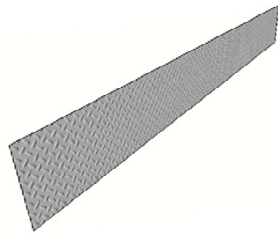

<u>PART DESC</u>	<u>MATERIAL</u>	<u>COLOUR</u>	<u>LENGTH MM</u>	<u>UNIT</u>
400MM KICK PLATE	ALY CHEQ	MILL	2500	EACH

REFERENCE

CFM-057

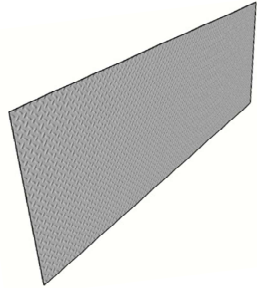

<u>PART DESC</u>	<u>MATERIAL</u>	<u>COLOUR</u>	<u>LENGTH MM</u>	<u>UNIT</u>
1250MM KICK PLATE	ALY CHEQ	MILL	2500	EACH

REFERENCE

CFM-058

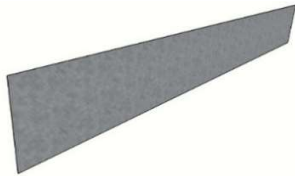

<u>PART DESC</u>	<u>MATERIAL</u>	<u>COLOUR</u>	<u>LENGTH MM</u>	<u>UNIT</u>
300MM KICK PLATE	GALV	MILL	2500	EACH

REFERENCE

CFM-059

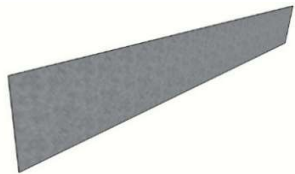

<u>PART DESC</u>	<u>MATERIAL</u>	<u>COLOUR</u>	<u>LENGTH MM</u>	<u>UNIT</u>
400MM KICK PLATE	GALV	MILL	2500	EACH

REFERENCE

CFM-060

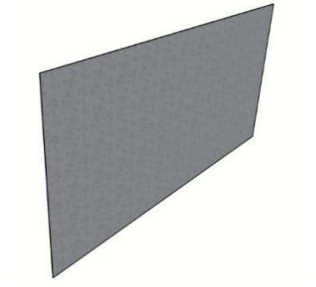

<u>PART DESC</u>	<u>MATERIAL</u>	<u>COLOUR</u>	<u>LENGTH MM</u>	<u>UNIT</u>
1250MM KICK PLATE	GALV	MILL	2500	EACH

REFERENCE

CFM-061



<u>PART DESC</u>	<u>MATERIAL</u>	<u>COLOUR</u>	<u>LENGTH MM</u>	<u>UNIT</u>
MESH SUPPORT BAR	GALV	MILL	3000	EACH

REFERENCE

CFM-062

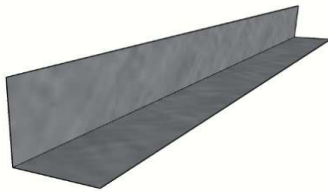

<u>PART DESC</u>	<u>MATERIAL</u>	<u>COLOUR</u>	<u>LENGTH MM</u>	<u>UNIT</u>
MESH SPRT 32X32	GALV	MILL	3000	EACH

REFERENCE

CFM-063

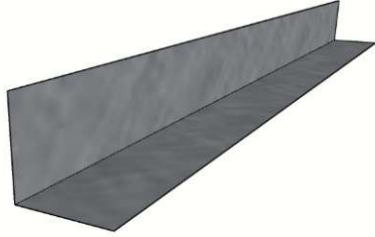

<u>PART DESC</u>	<u>MATERIAL</u>	<u>COLOUR</u>	<u>LENGTH MM</u>	<u>UNIT</u>
MESH SPRT 40X40	GALV	MILL	3000	EACH

REFERENCE

CFM-064

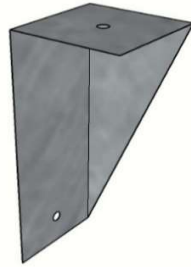

<u>PART DESC</u>	<u>MATERIAL</u>	<u>COLOUR</u>	<u>LENGTH MM</u>	<u>UNIT</u>
CEILING BRACKET	GALV	MILL	175	EACH

REFERENCE

CFM-065

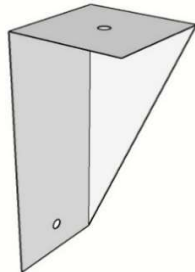

<u>PART DESC</u>	<u>MATERIAL</u>	<u>COLOUR</u>	<u>LENGTH MM</u>	<u>UNIT</u>
CEILING BRACKET	GALV / PPC	WHITE	175	EACH

REFERENCE

CFM-066

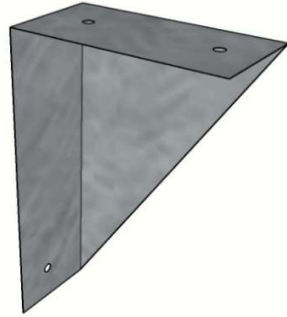

<u>PART DESC</u>	<u>MATERIAL</u>	<u>COLOUR</u>	<u>LENGTH MM</u>	<u>UNIT</u>
LARGE CEILING BRKT	GALV	MILL	200	EACH

REFERENCE

CFM-067

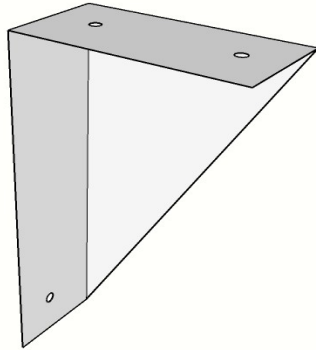

<u>PART DESC</u>	<u>MATERIAL</u>	<u>COLOUR</u>	<u>LENGTH MM</u>	<u>UNIT</u>
LARGE CEILING BRKT	GALV / PPC	WHITE	200	EACH

REFERENCE

CFM-068

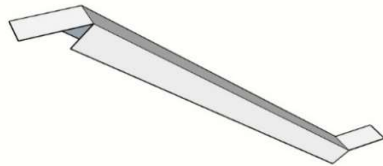

<u>PART DESC</u>	<u>MATERIAL</u>	<u>COLOUR</u>	<u>LENGTH M</u>	<u>UNIT</u>
CEILING BRACE	H.G.P.	WHITE	400	EACH

REFERENCE

CFM-069

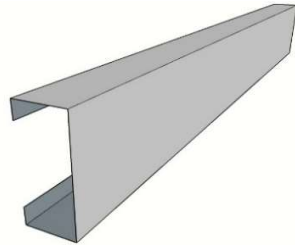

<u>PART DESC</u>	<u>MATERIAL</u>	<u>COLOUR</u>	<u>LENGTH M</u>	<u>UNIT</u>
PANEL STIFFENER	NON-PRIME	REVERSE	496	EACH

REFERENCE

CFM-070

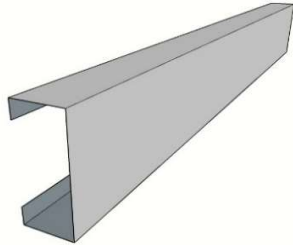

<u>PART DESC</u>	<u>MATERIAL</u>	<u>COLOUR</u>	<u>LENGTH M</u>	<u>UNIT</u>
FLAT PANEL STFNR	NON-PRIME	REVERSE	496	EACH

REFERENCE

CFM-071

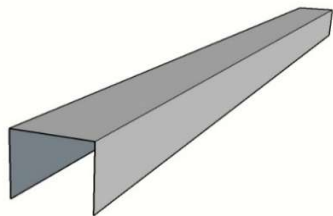

<u>PART DESC</u>	<u>MATERIAL</u>	<u>COLOUR</u>	<u>LENGTH M</u>	<u>UNIT</u>
PANEL INSERT	NON-PRIME	REVERSE	470	EACH

REFERENCE

CFM-072

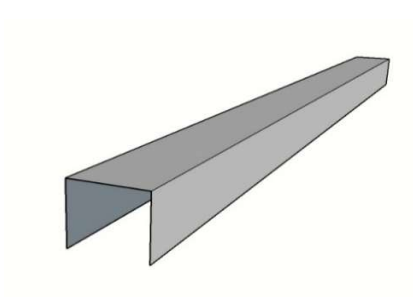

<u>PART DESC</u>	<u>MATERIAL</u>	<u>COLOUR</u>	<u>LENGTH M</u>	<u>UNIT</u>
FLAT PANEL INSERT	NON-PRIME	REVERSE	470	EACH

REFERENCE

CFM-073

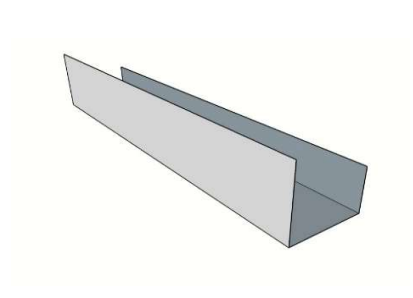

<u>PART DESC</u>	<u>MATERIAL</u>	<u>COLOUR</u>	<u>LENGTH M</u>	<u>UNIT</u>
JOINT CLAMP	PLASTISOL	WHITE	200	EACH

REFERENCE

CFM-074

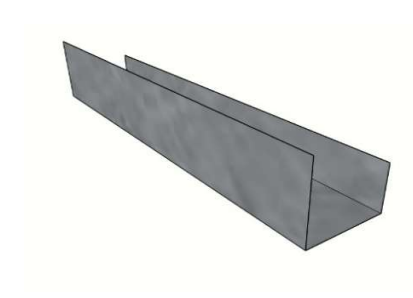

<u>PART DESC</u>	<u>MATERIAL</u>	<u>COLOUR</u>	<u>LENGTH M</u>	<u>UNIT</u>
JOINT CLAMP	GALV	MILL	496	EACH

REFERENCE

CFM-075

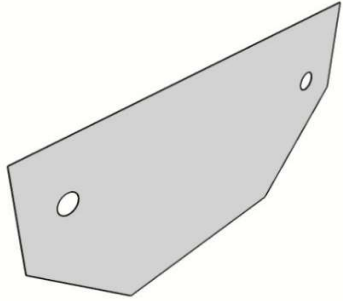

<u>PART DESC</u>	<u>MATERIAL</u>	<u>COLOUR</u>	<u>LENGTH M</u>	<u>UNIT</u>
DOUBLE DOOR STOP	GALV / PPC	WHITE	100	EACH

REFERENCE

CFM-076

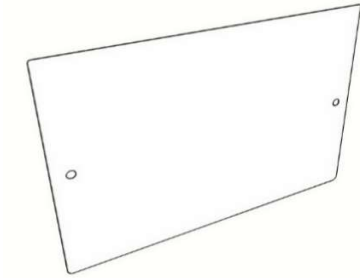

<u>PART DESC</u>	<u>MATERIAL</u>	<u>COLOUR</u>	<u>LENGTH M</u>	<u>UNIT</u>
DOOR No MOUNT	H.G.P.	WHITE	100	EACH

REFERENCE

CFM-077

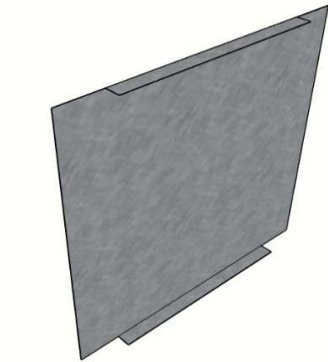

<u>PART DESC</u>	<u>MATERIAL</u>	<u>COLOUR</u>	<u>LENGTH M</u>	<u>UNIT</u>
ROLLER BRACKET	GALV	MILL	500	EACH

REFERENCE

CFM-078

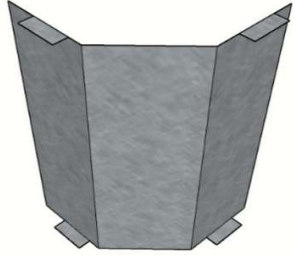

<u>PART DESC</u>	<u>MATERIAL</u>	<u>COLOUR</u>	<u>LENGTH M</u>	<u>UNIT</u>
ROLLER BRKT FAC	GALV	MILL	500	EACH

REFERENCE

CFM-079

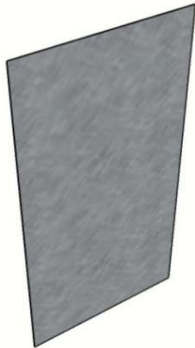

<u>PART DESC</u>	<u>MATERIAL</u>	<u>COLOUR</u>	<u>LENGTH M</u>	<u>UNIT</u>
ROLLER BRKT SMALL	GALV	MILL	250	EACH

REFERENCE

CFM-080

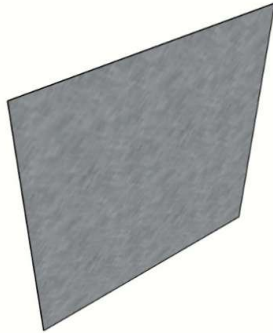

<u>PART DESC</u>	<u>MATERIAL</u>	<u>COLOUR</u>	<u>LENGTH M</u>	<u>UNIT</u>
ROLLER BRKT LARGE	GALV	MILL	500	EACH

REFERENCE

CFM-081

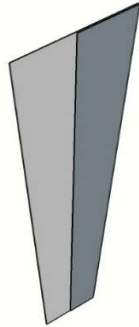

<u>PART DESC</u>	<u>MATERIAL</u>	<u>COLOUR</u>	<u>LENGTH M</u>	<u>UNIT</u>
DOOR STRIP 1	PLASTISOL			PLM

REFERENCE

CFM-082

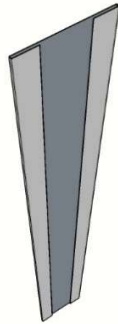

<u>PART DESC</u>	<u>MATERIAL</u>	<u>COLOUR</u>	<u>LENGTH M</u>	<u>UNIT</u>
DOOR STRIP 2	H.G.P.	WHITE		PLM

REFERENCE

CFM-083

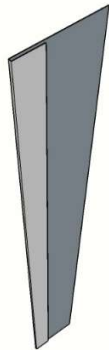

<u>PART DESC</u>	<u>MATERIAL</u>	<u>COLOUR</u>	<u>LENGTH M</u>	<u>UNIT</u>
DOOR STRIP 3	PLASTISOL			PLM

REFERENCE

CFM-086



<u>PART DESC</u>	<u>MATERIAL</u>	<u>COLOUR</u>	<u>LENGTH M</u>	<u>UNIT</u>
MULLION POST	MILD STEEL	MILL		PLM

REFERENCE

CFM-087

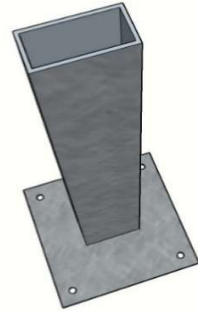

<u>PART DESC</u>	<u>MATERIAL</u>	<u>COLOUR</u>	<u>LENGTH M</u>	<u>UNIT</u>
MULLION POST 2	MILD STEEL	MILL		PLM

REFERENCE

CFM-088

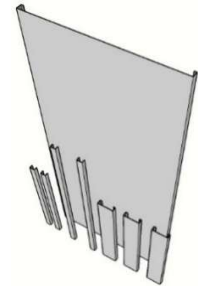

<u>PART DESC</u>	<u>MATERIAL</u>	<u>COLOUR</u>	<u>LENGTH M</u>	<u>UNIT</u>
SFT PNL SET 800MM	H.G.P.	WHITE	2500	EACH

REFERENCE

CFM-001

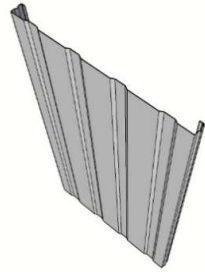

<u>PART DESC</u>	<u>MATERIAL</u>	<u>COLOUR</u>	<u>LENGTH MM</u>	<u>UNIT £</u>
SOFFIT PANEL	H.G.P.	WHITE		PLM

REFERENCE

CFM-089

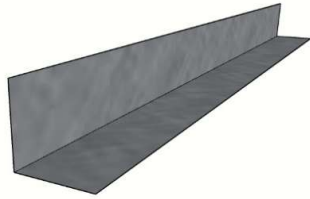

<u>PART DESC</u>	<u>MATERIAL</u>	<u>COLOUR</u>	<u>LENGTH MM</u>	<u>UNIT</u>
ANGLE 55X25	GALV	MILL		PLM

REFERENCE

CFM-092

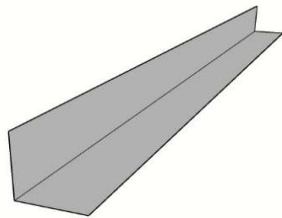

<u>PART DESC</u>	<u>MATERIAL</u>	<u>COLOUR</u>	<u>LENGTH MM</u>	<u>UNIT</u>
MESH SPRT 32X32	HGP	WHITE		PLM

<u>REFERENCE</u>	<u>DOOR TYPE</u>	<u>DOOR WIDTH</u>	<u>COLOUR</u>	<u>LATCH PREP</u>	<u>DOOR HEIGHT</u>	<u>UNIT</u>
CFM-100	FLAT 3 STIFFENERS					EACH

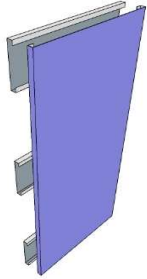

<u>REFERENCE</u>	<u>DOOR TYPE</u>	<u>DOOR WIDTH</u>	<u>COLOUR</u>	<u>LATCH PREP</u>	<u>DOOR HEIGHT</u>	<u>UNIT</u>
CFM-101	FLAT 4 STIFFENERS LATCH PREP					EACH

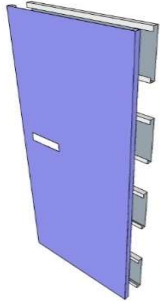

<u>REFERENCE</u>	<u>DOOR TYPE</u>	<u>DOOR WIDTH</u>	<u>COLOUR</u>	<u>LATCH PREP</u>	<u>DOOR HEIGHT</u>	<u>UNIT</u>
CFM-102	FLAT SINGLE LIP 3 STIFFENERS					EACH

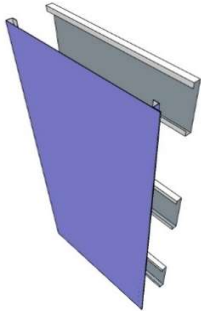

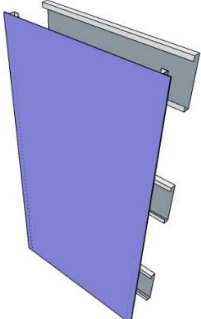
<u>REFERENCE</u>		<u>DOOR TYPE</u>	<u>DOOR WIDTH</u>	<u>COLOUR</u>	<u>LATCH PREP</u>	<u>DOOR HEIGHT</u>	<u>UNIT</u>
CFM-103		FLAT DOUBLE LIP 3 STIFFENERS					EACH

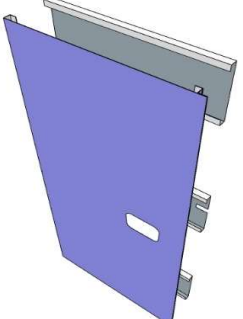
<u>REFERENCE</u>		<u>DOOR TYPE</u>	<u>DOOR WIDTH</u>	<u>COLOUR</u>	<u>LATCH PREP</u>	<u>DOOR HEIGHT</u>	<u>UNIT</u>
CFM-104		FLAT DOUBLE LIP 3 STIFFENERS LATCH & MID STIFFENER PREP					EACH

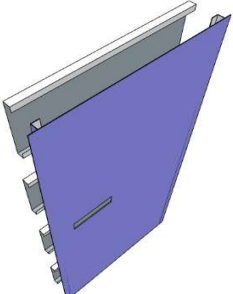
<u>REFERENCE</u>		<u>DOOR TYPE</u>	<u>DOOR WIDTH</u>	<u>COLOUR</u>	<u>LATCH PREP</u>	<u>DOOR HEIGHT</u>	<u>UNIT</u>
CFM-105		FLAT DOUBLE LIP 4 STIFFENERS LATCH PREP					EACH

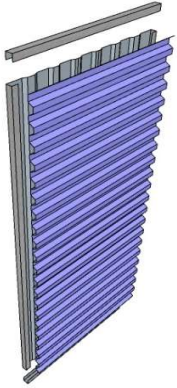
REFERENCE		DOOR TYPE	DOOR WIDTH	COLOUR	LATCH PREP	DOOR HEIGHT	UNIT
CFM-106		CORRUGATED DOOR LATCH PREP					EACH

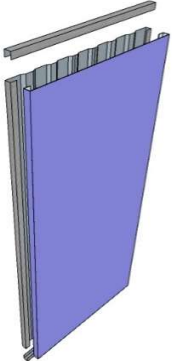
REFERENCE		DOOR TYPE	DOOR WIDTH	COLOUR	LATCH PREP	DOOR HEIGHT	UNIT
CFM-107		FLAT DOOR CORRUGATED REAR					EACH

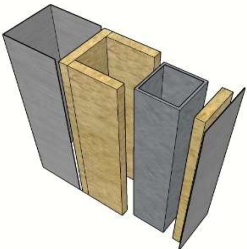
REFERENCE		PART DESC	MATERIAL	COLOUR	LENGTH MM	UNIT
CFM-201		COLUMN CASE	GALV	MILL		PLM

REFERENCE

CFM-202

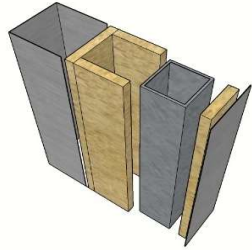

COLUMN CASE

PART DESC MATERIAL COLOUR LENGTH MM UNIT

CC FOR 90X90 SECTION GALV MILL PLM

REFERENCE

CFM-203

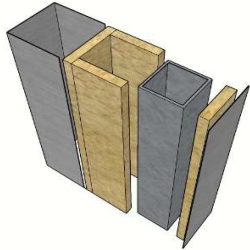

COLUMN CASE

PART DESC MATERIAL COLOUR LENGTH MM UNIT

CC FOR 100X100 SECTION GALV MILL PLM

REFERENCE

CFM-204

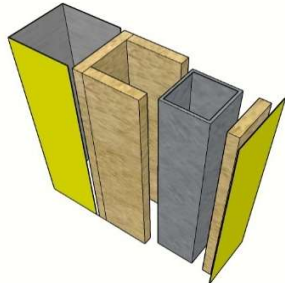

COLUMN CASE

PART DESC MATERIAL COLOUR LENGTH MM UNIT

CC FOR 80X80 SECTION PLAS PLM

REFERENCE

CFM-205

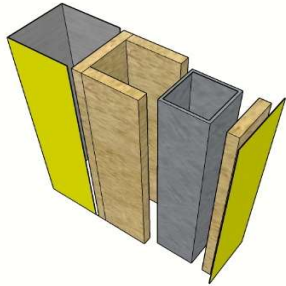

COLUMN CASE

<u>PART DESC</u>	<u>MATERIAL</u>	<u>COLOUR</u>	<u>LENGTH MM</u>	<u>UNIT</u>
CC FOR 90X90 SECTION	PLAS			PLM

REFERENCE

CFM-206

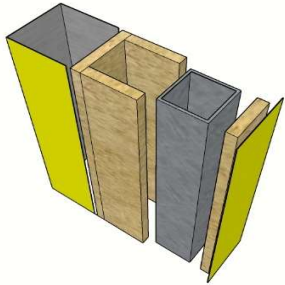

COLUMN CASE

<u>PART DESC</u>	<u>MATERIAL</u>	<u>COLOUR</u>	<u>LENGTH MM</u>	<u>UNIT</u>
CC FOR 100X100 SECTION	PLAS			PLM

REFERENCE

CFM-093



<u>PART DESC</u>	<u>MATERIAL</u>	<u>COLOUR</u>	<u>LENGTH M</u>	<u>UNIT</u>
CORRIDOR FILLER	FOAM	ANTHRACITE	495	EACH